

- Montageanleitung
- Assembly instructions
- Notice de montage
- Montagehandleiding
- Návod na montáž
- Instrucțiune de montaj
- Navodila za namestitev
- Installationstruktioener

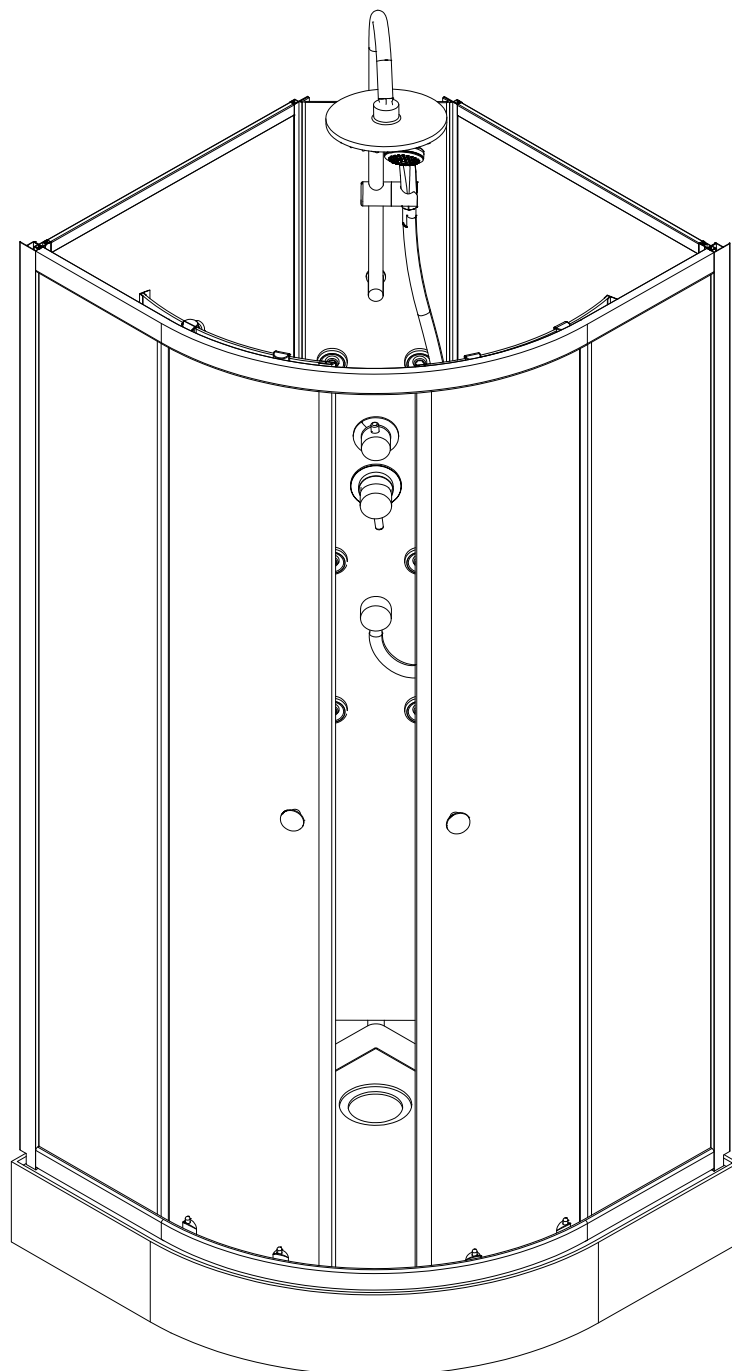

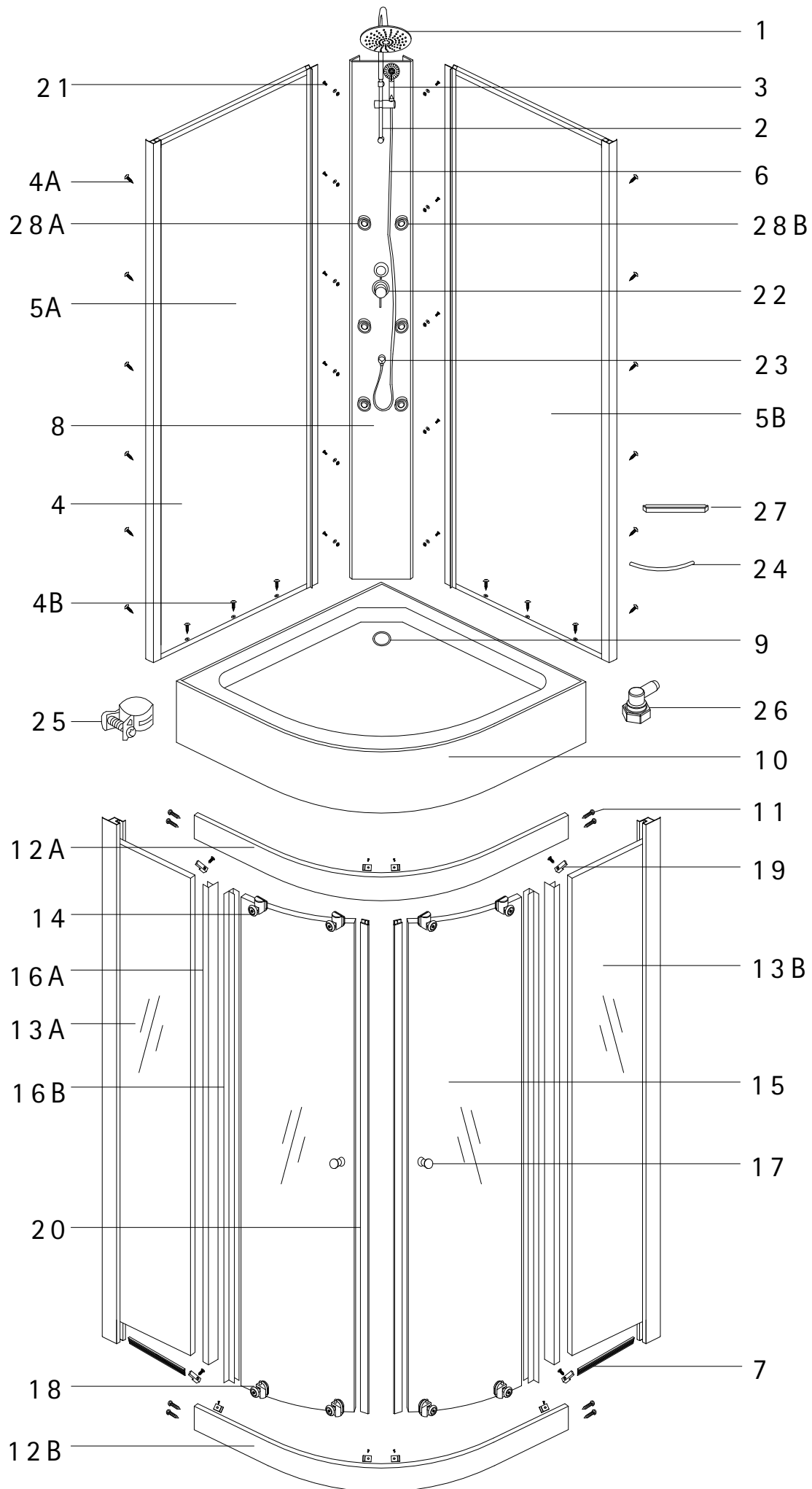

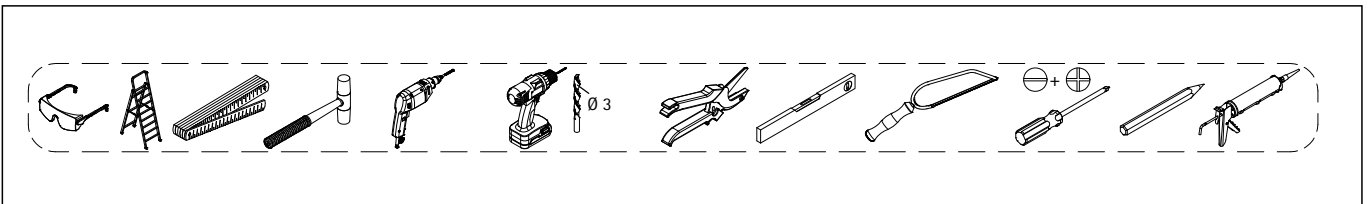

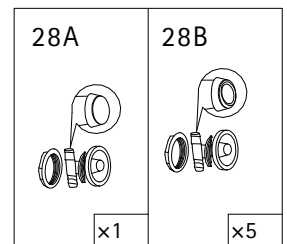
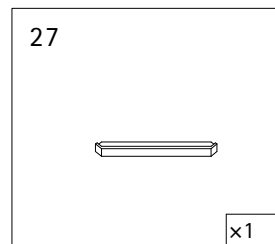
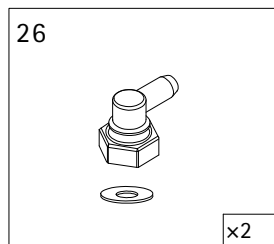
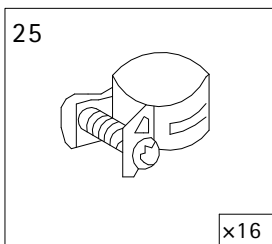
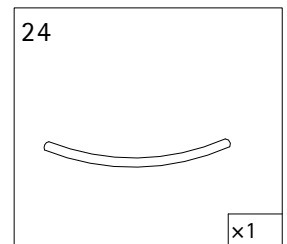
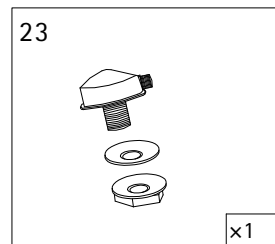
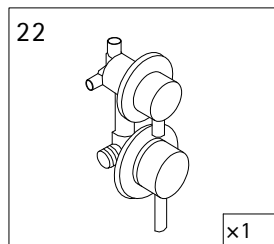
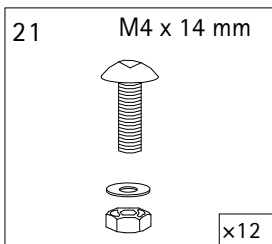
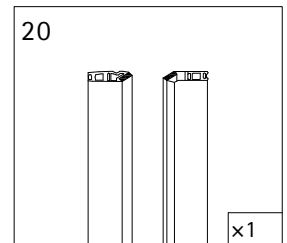
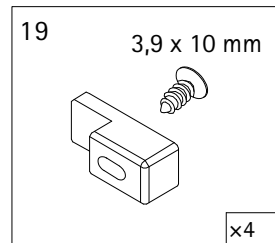
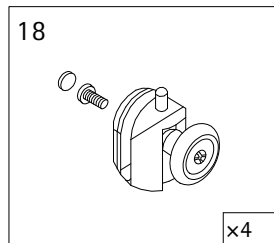
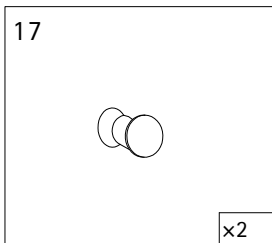
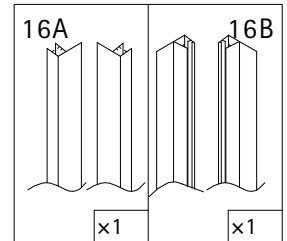
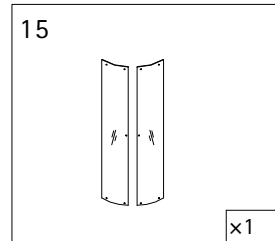
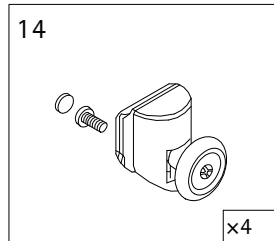
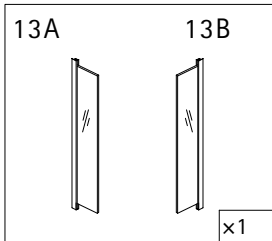
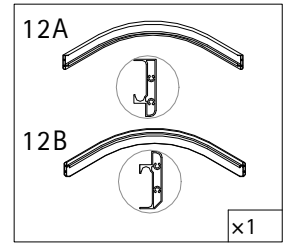
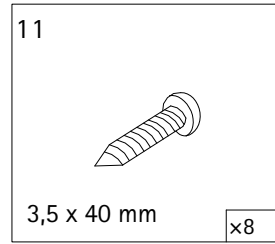
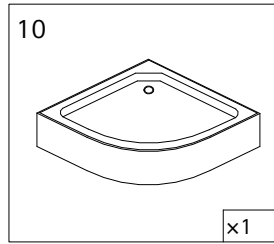
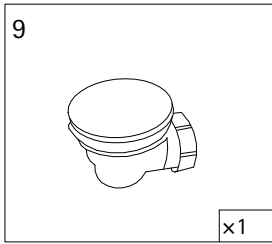
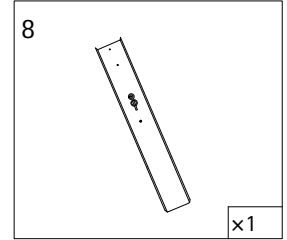
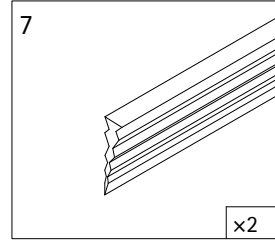
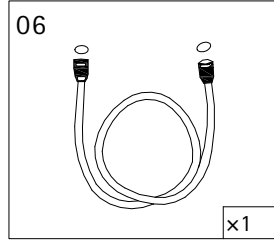
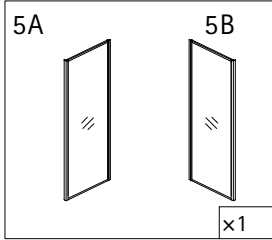
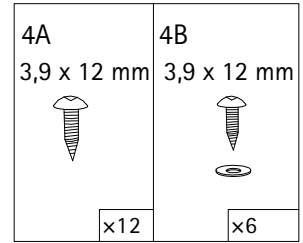
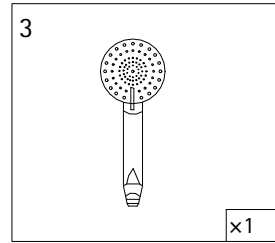
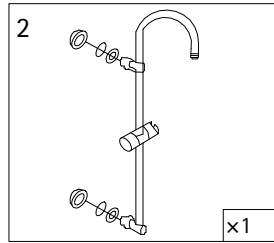
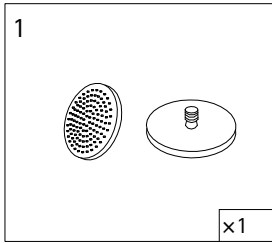
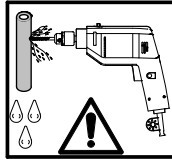
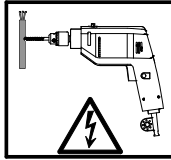
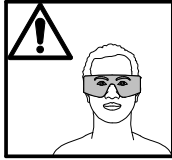
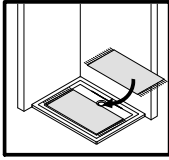

Pos. 9

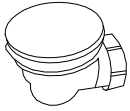

x1

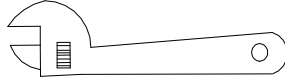

Pos. 10

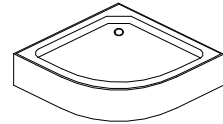

x1

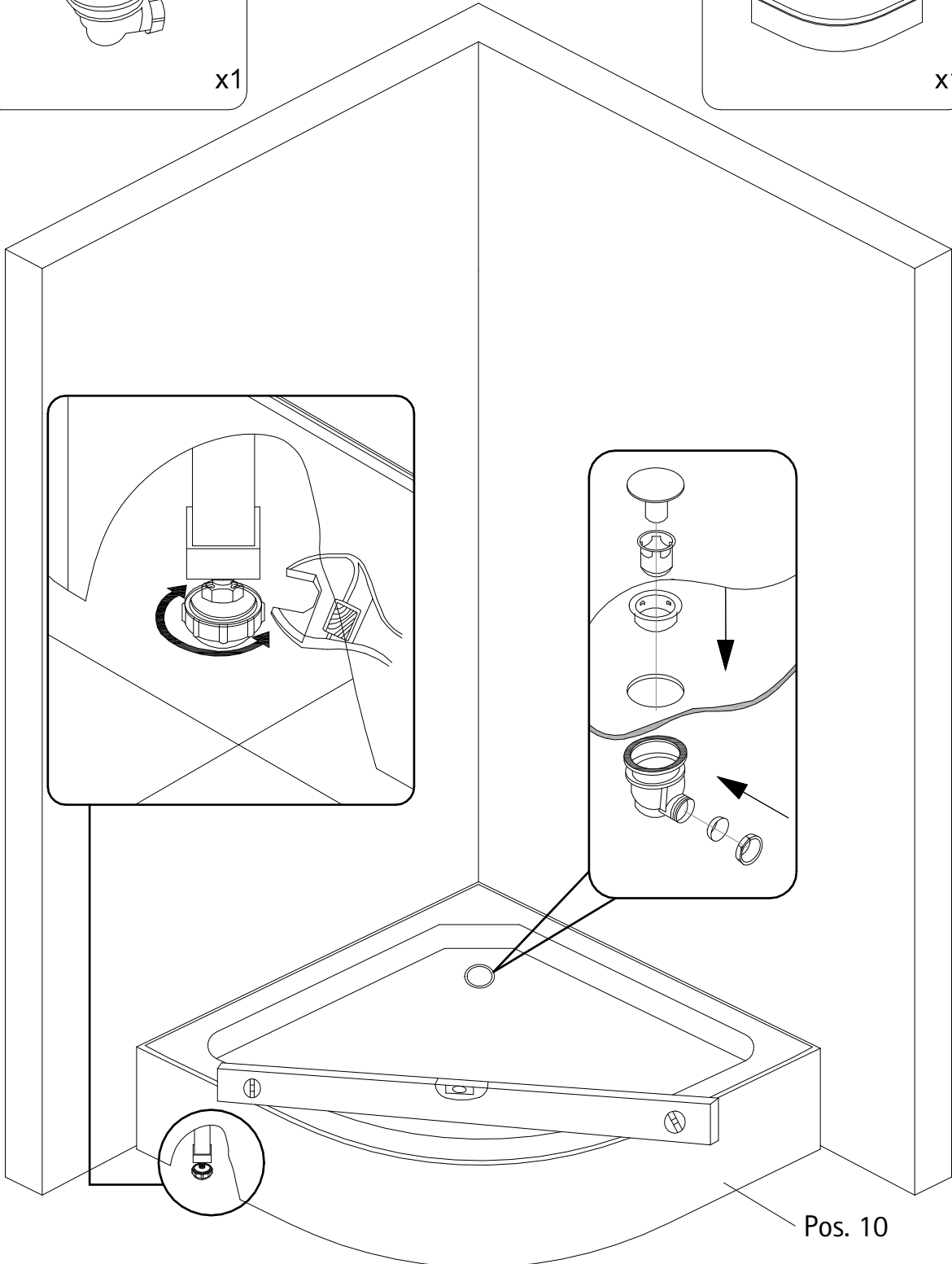

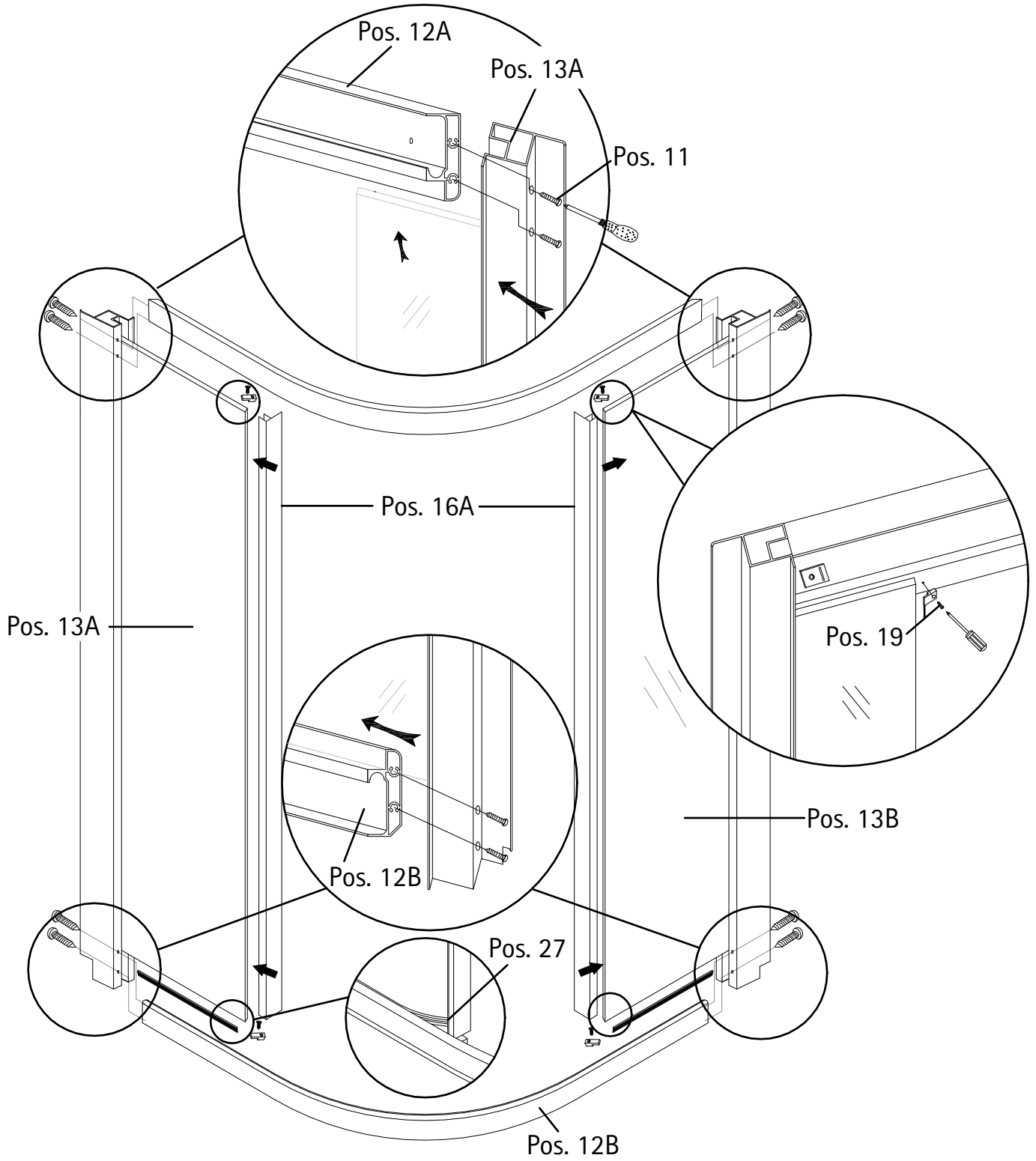
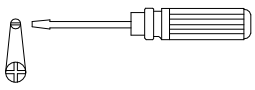
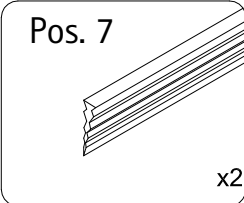
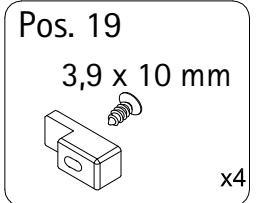
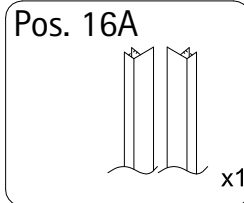
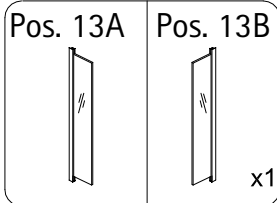
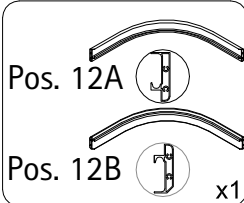
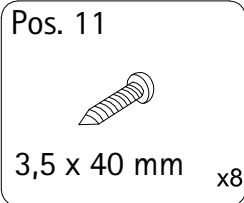

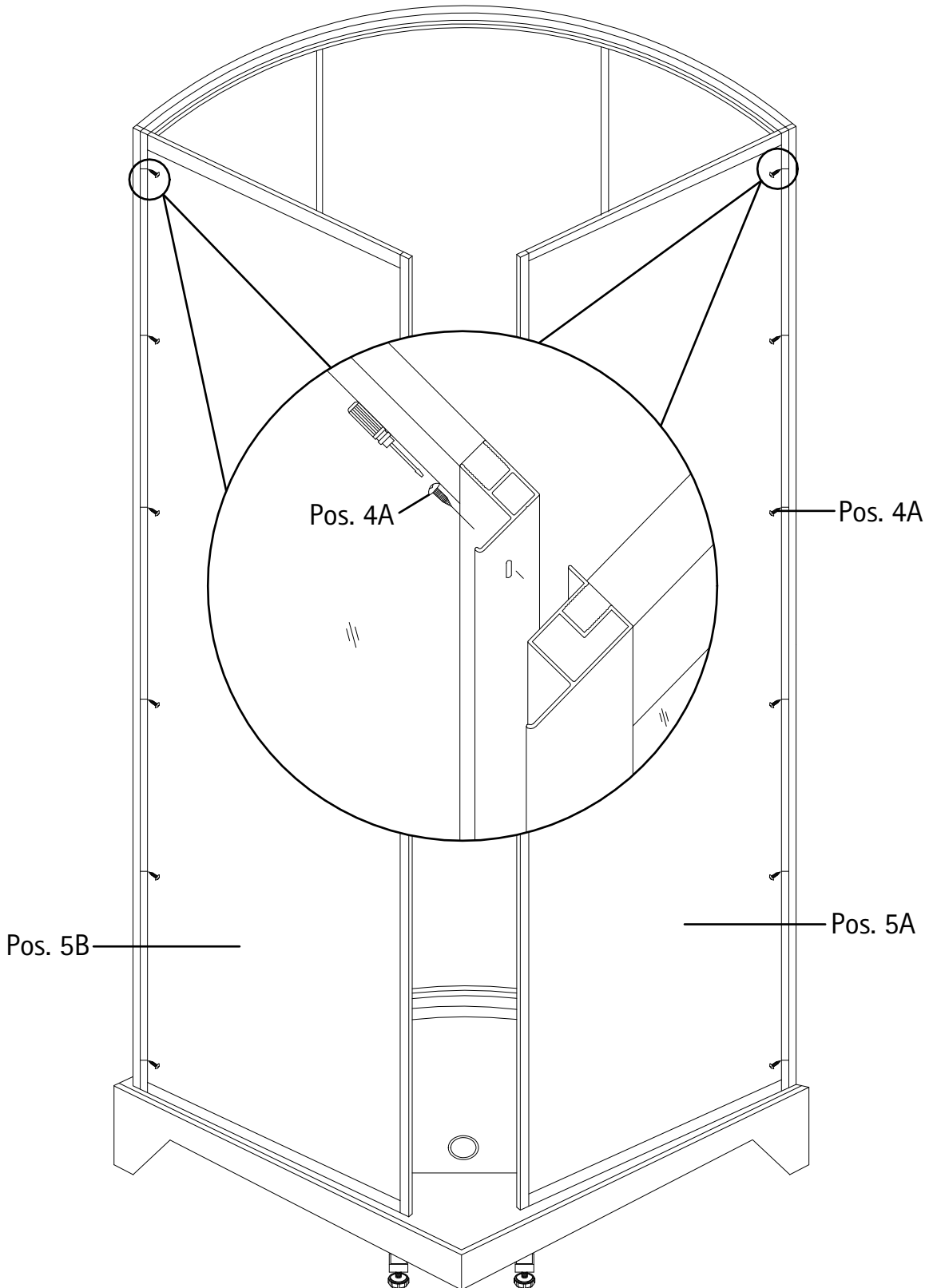
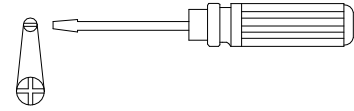
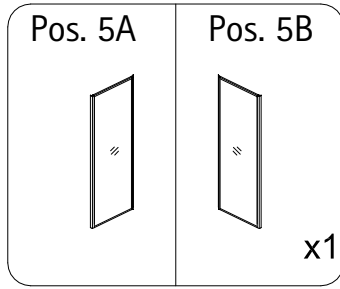
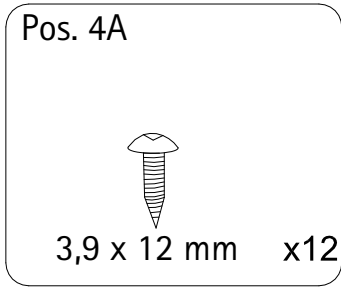

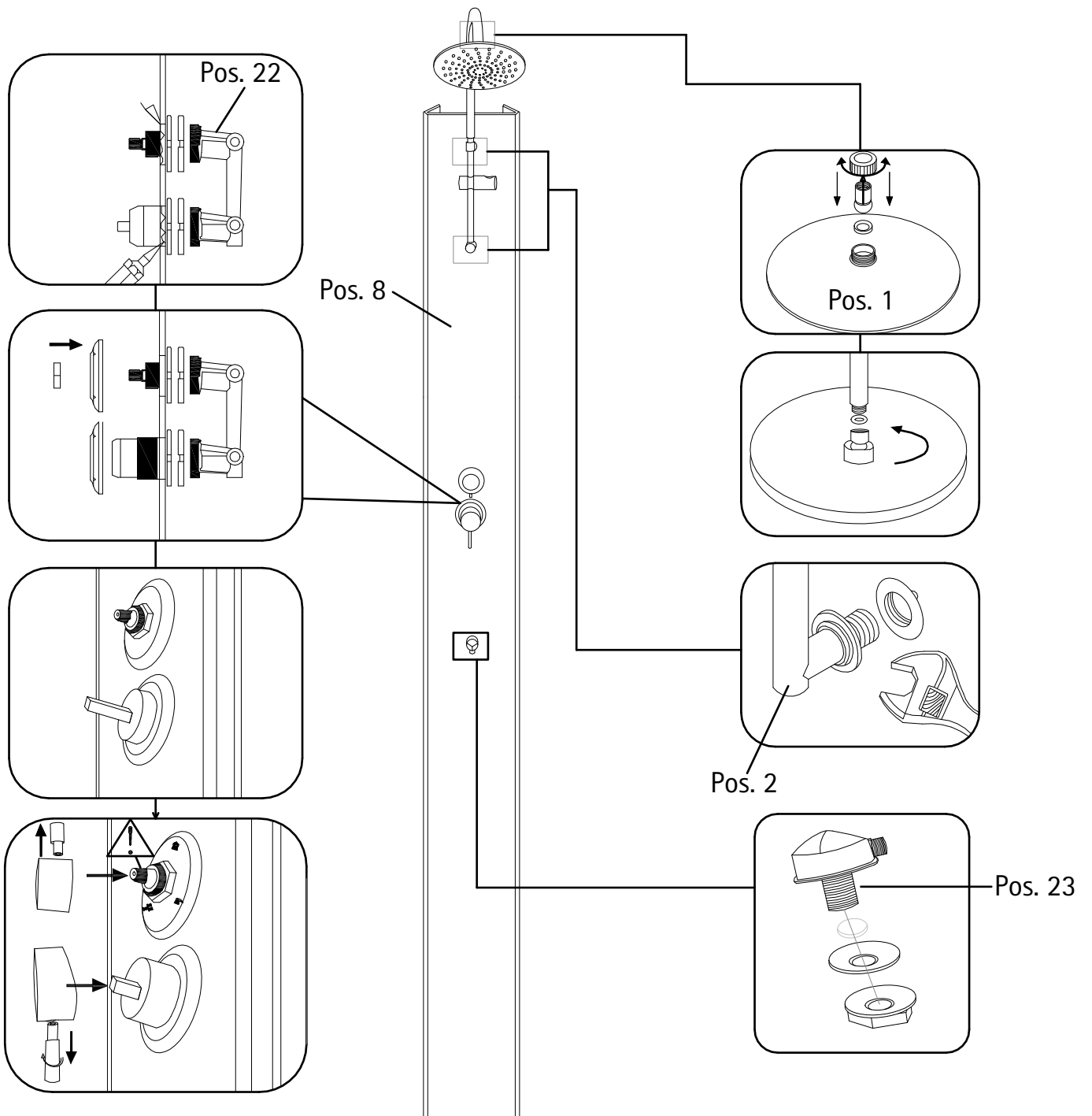
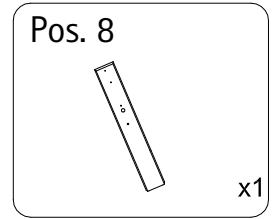
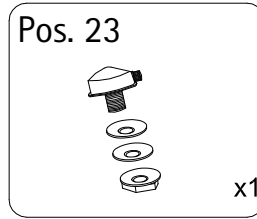
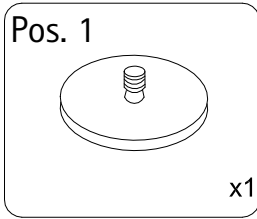
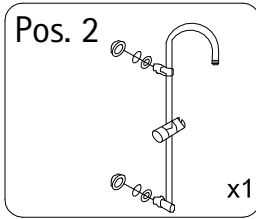
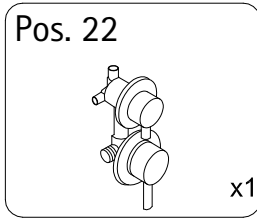
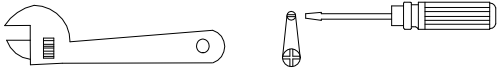

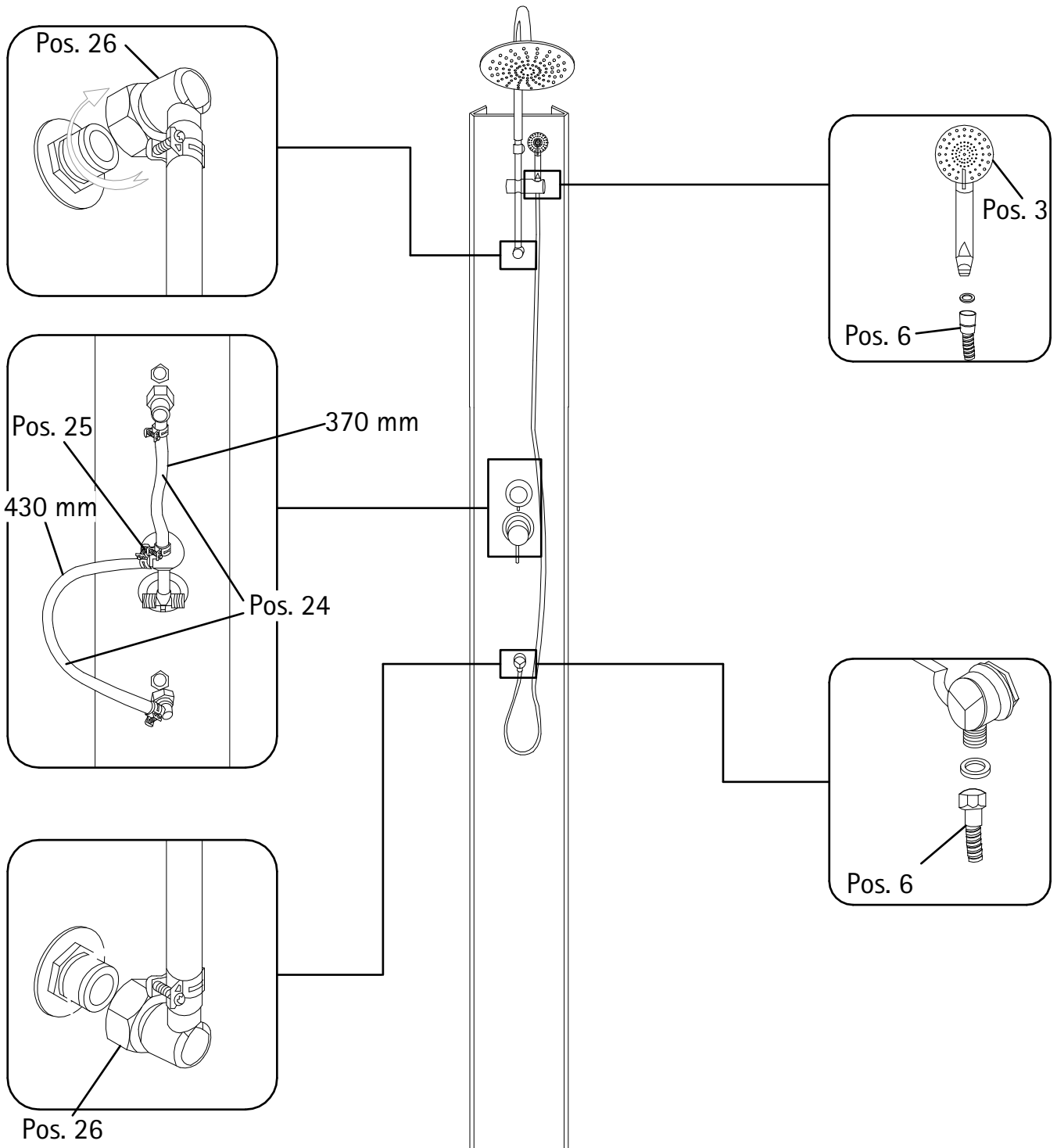
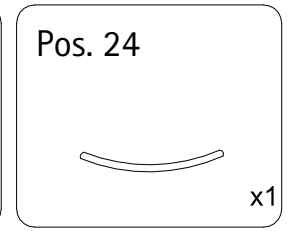
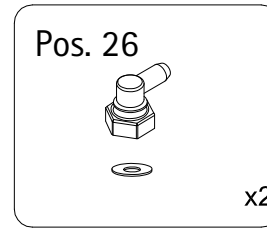
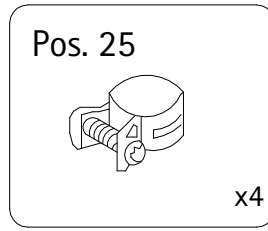
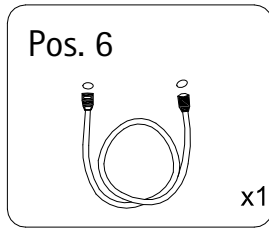
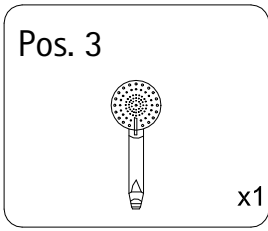
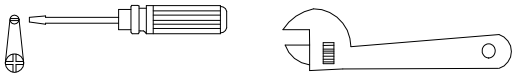



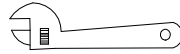
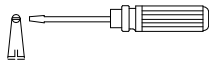

Pos. 4B

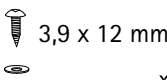

3,9 x 12 mm

x6

Pos. 28

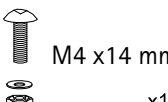

M4 x14 mm

x12

Pos. 8

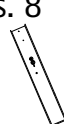

x1

Pos. 27



x1

Pos. 28A



x1

Pos. 28B



x1

Pos. 24



x1

Pos. 25

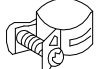

x12

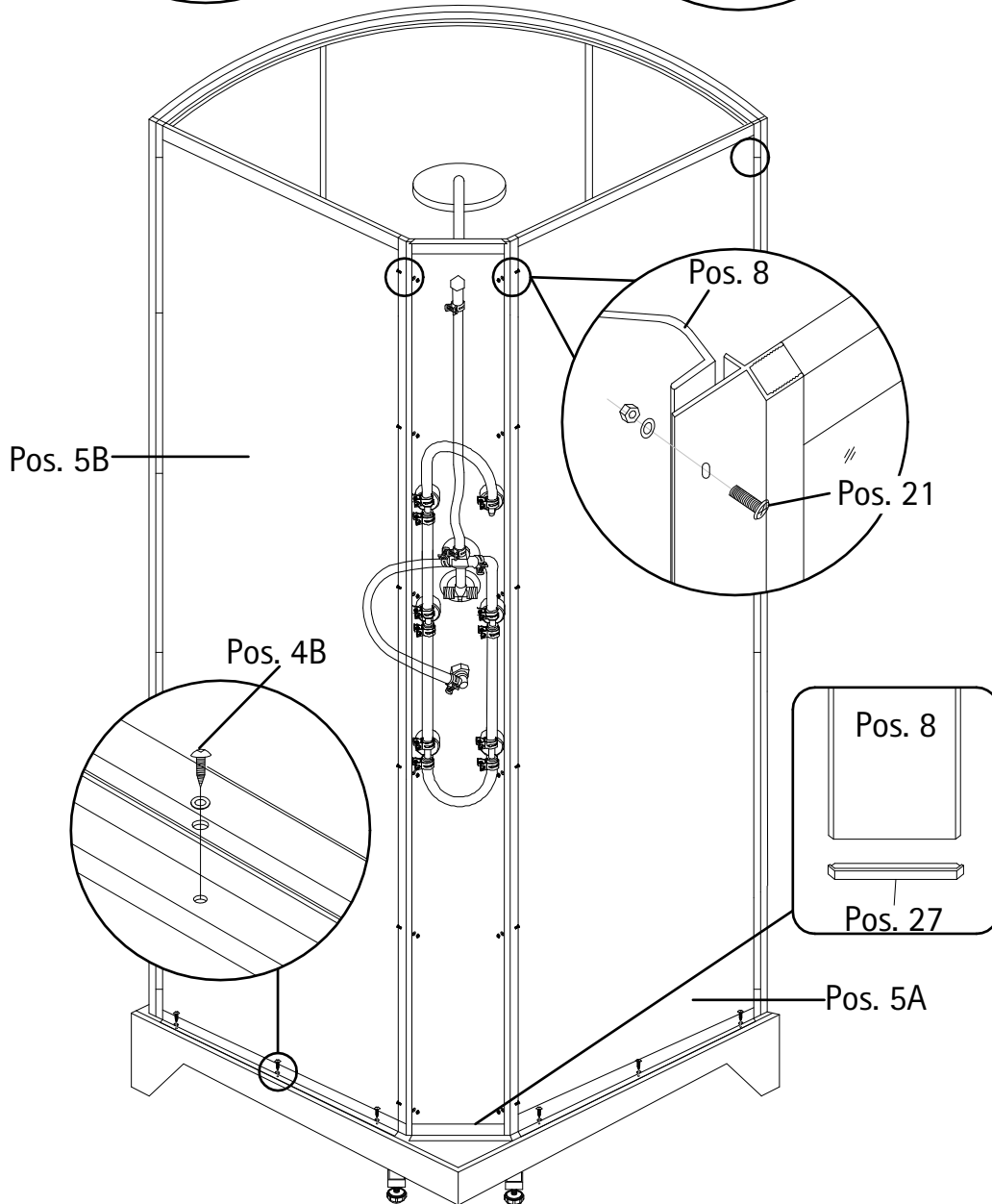
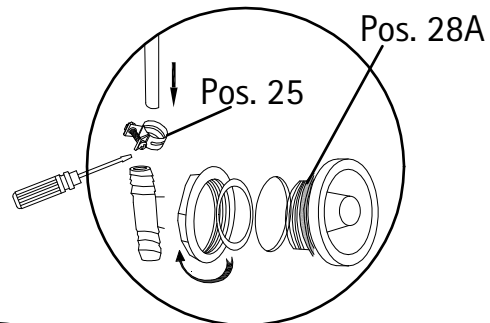
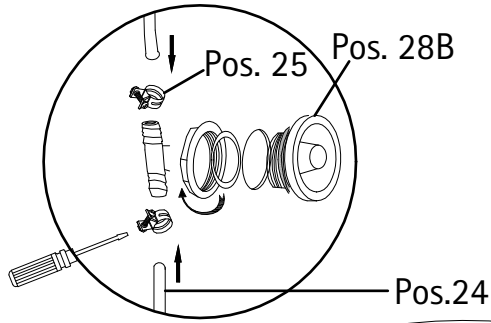

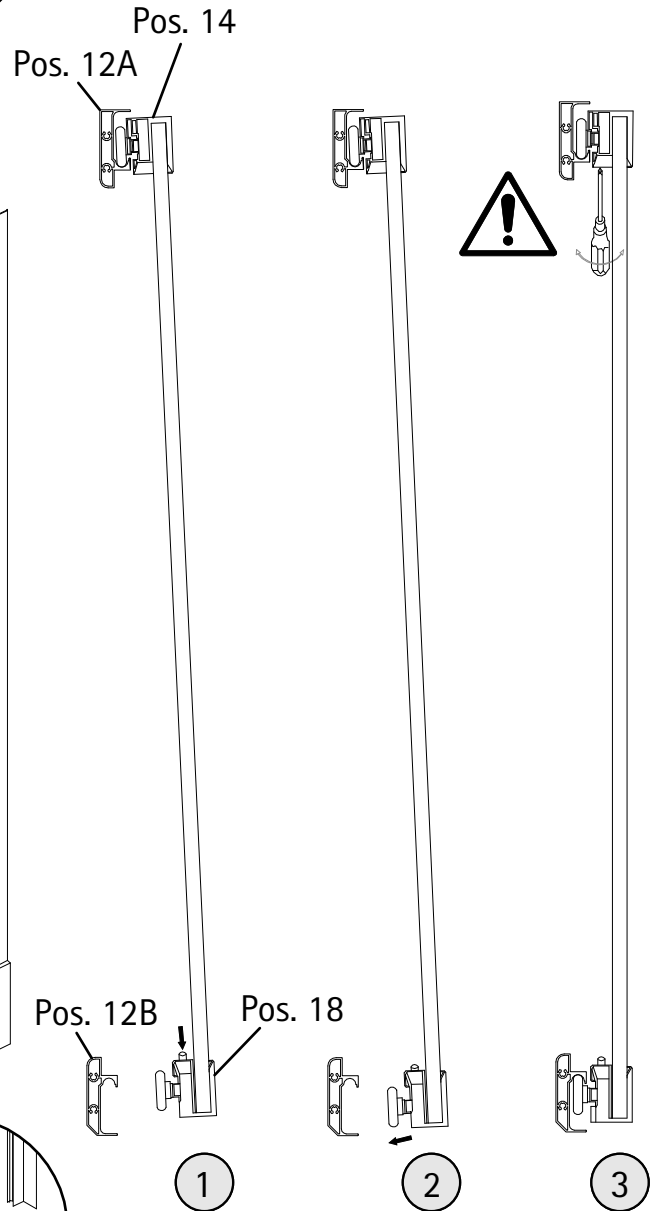
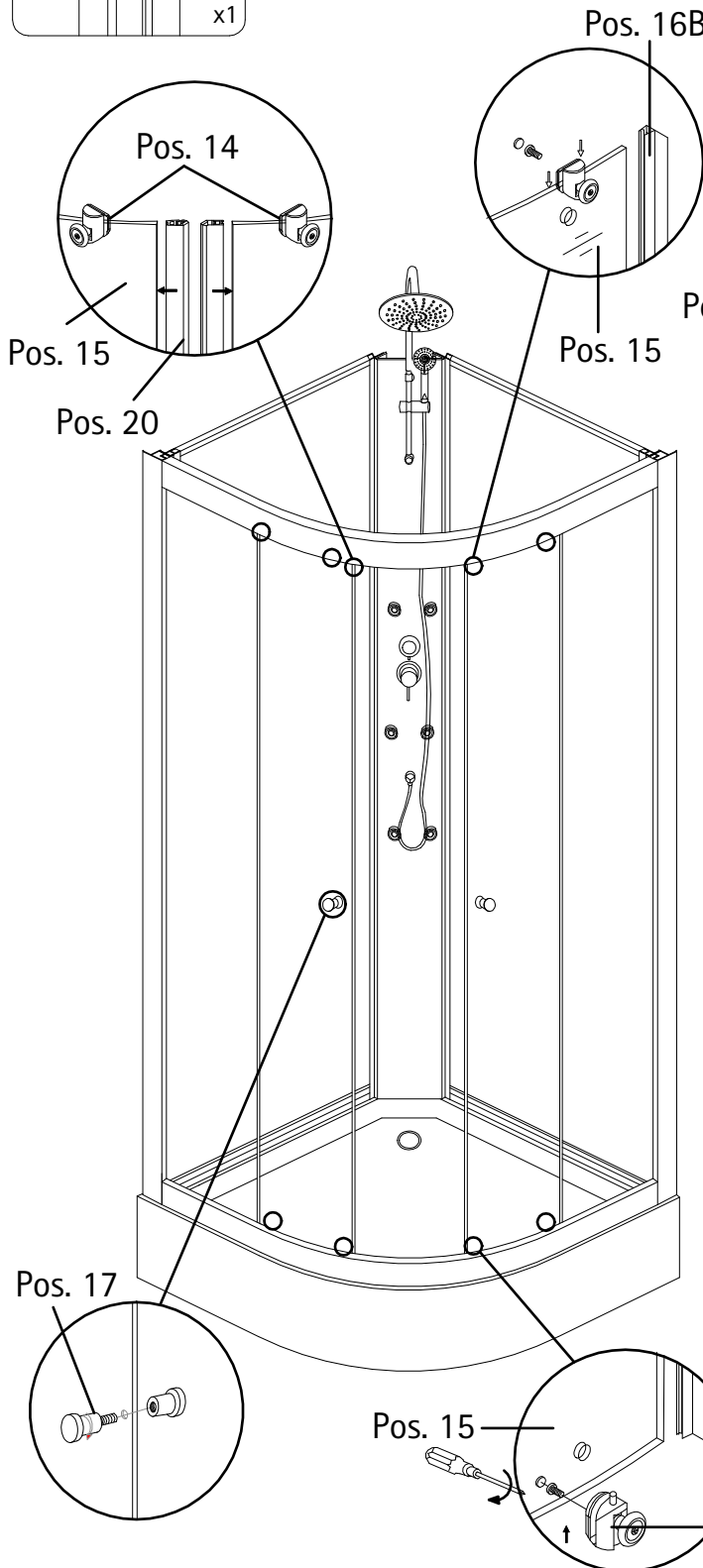
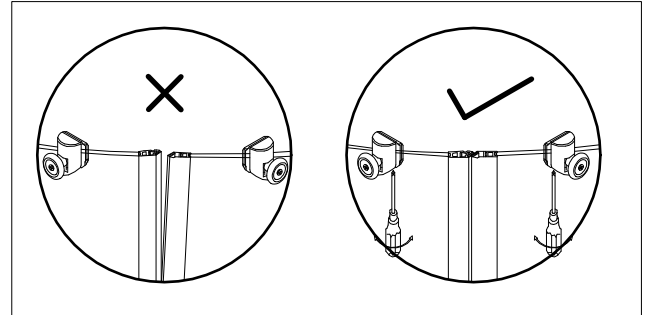
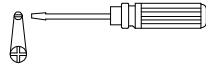
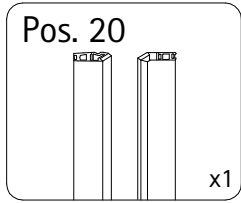
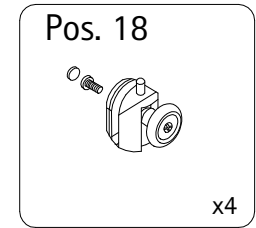
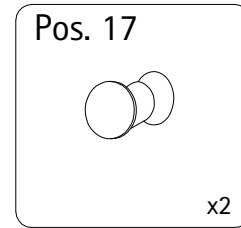
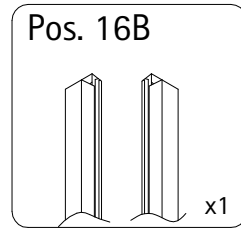
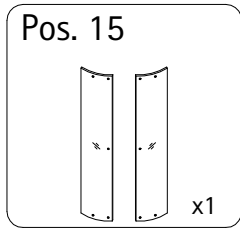
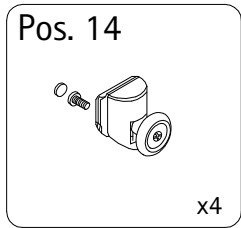

# Notizen, notes, notities

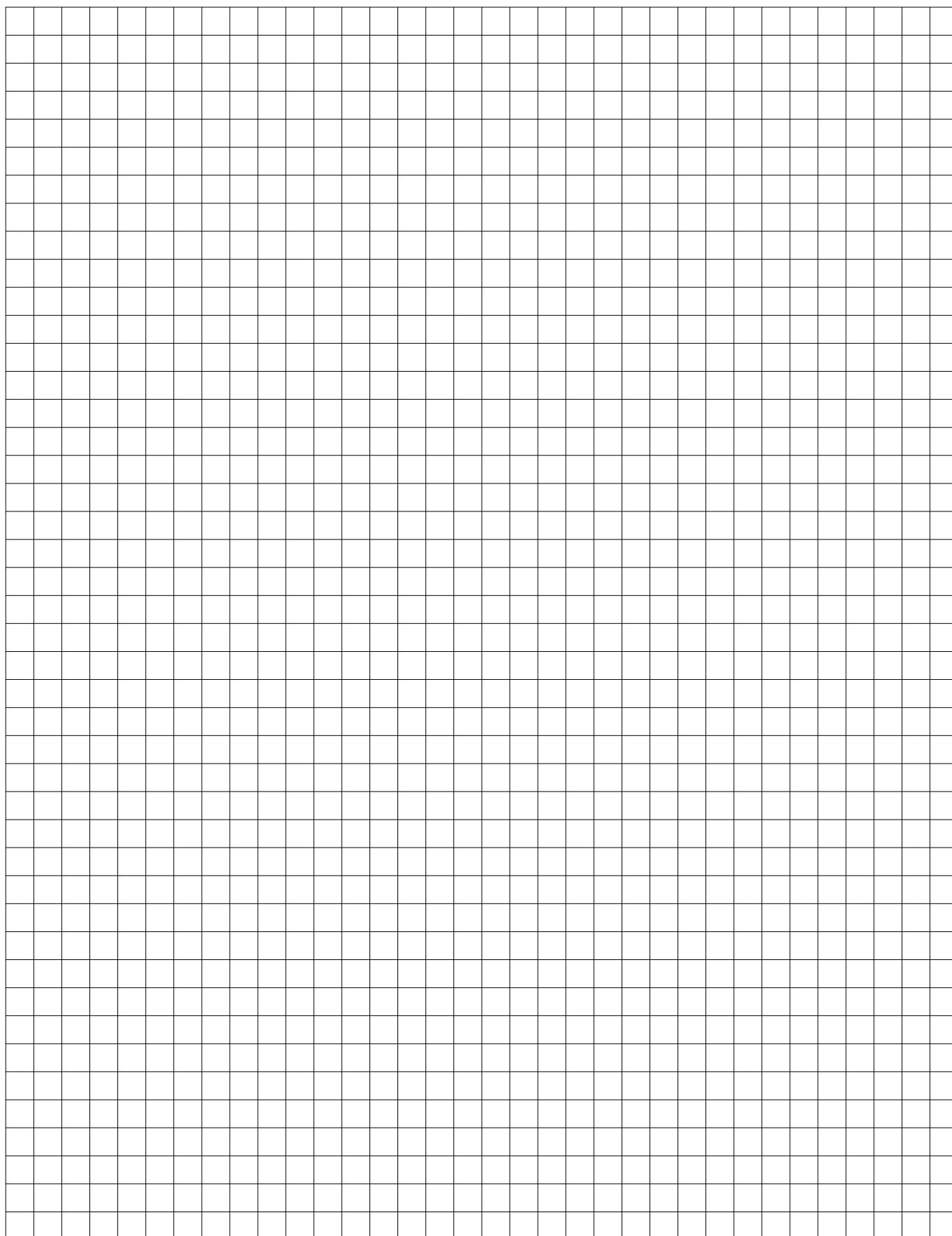

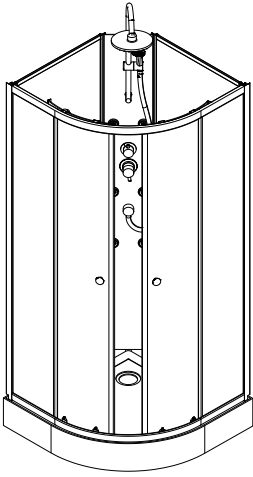

1916-1

Kontrollbeleg  
Control Receipt

Prüfnummer/ Inspection number

---



Duschkabinenbau  
Am Lindhövel 1  
59846 Sundern  
Deutschland / Germany / Allemagne / Duitsland



Allgemeine technische Probleme:  
Telefon 02935 / 96 53 444



E-Mail:  
[onlineservice@duschtec.de](mailto:onlineservice@duschtec.de)